

VERY EASY TOTE

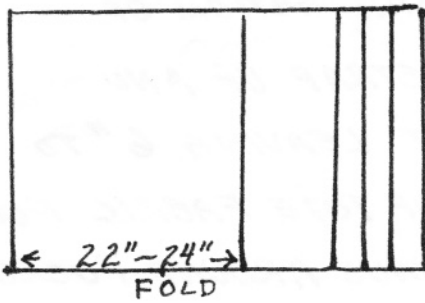

FABRIC:

1yd minimum 42"-44" WIDE

CUT:

1- 22" W OR 24" W WOF (TOTE BODY)

3- 3" WOF STRIPS (STRAPS)

1- 6½" X 18" RECTANGLE (POCKET)

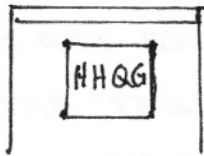
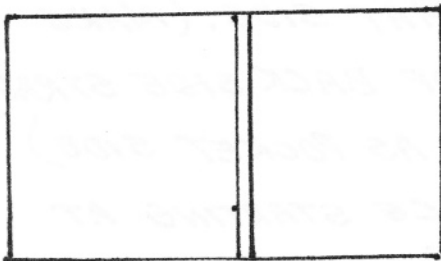

△ OPEN TOTE BODY FABRIC MARK CENTER

△ PREPARE POCKET

FOLD DOWN 2½" ON 6½" SIDE
AND STITCH IN PLACE (TOP STITCH
EDGE) SEW ON HHQG LABEL

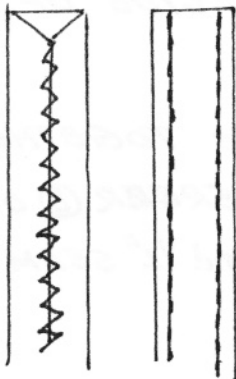

△ PREPARE STRAPS

- JOIN STRIPS TO FORM ONE PIECE
FOLD EDGES TO CENTER (BOTH
SIDES TOUCHING IN CENTER) PRESS
- USING ZIGZAG STITCH SEW
SIDE DOWN AND TOGETHER
- TOP STITCH BOTH SIDES OF STRAPS

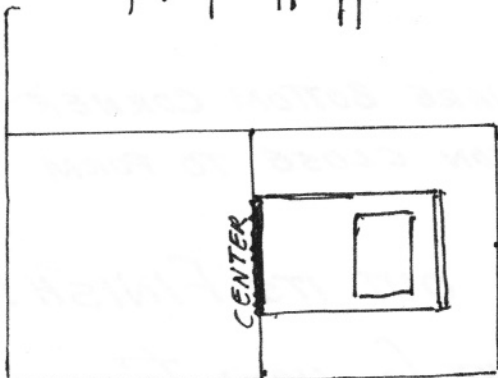

△ CENTER POCKET ON RIGHT SIDE
OF TOTE BODY

- STITCH DOWN ON CENTER LINE
MARK CLOSING BOTTOM OF POCKET

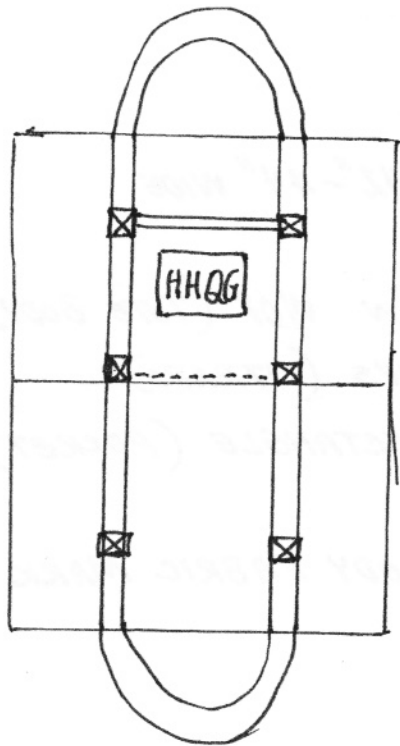

△ PLACE AND PIN STRAPS STARTING AT CENTER MARK BOTTOM OF POCKET. WRAP STRAP UP AND AROUND POCKET LEAVING 6" TO 10" ABOVE TOP OF TOTE FABRIC FOR HANDLE. CONTINUE AROUND POCKET TO TOP OF TOTE BACK SIDE REPEAT 6" TO 10" ABOVE TOP OF FABRIC FOR HANDLE ON THAT SIDE. (MAKE SURE WIDTH OF BACK SIDE STRAP IS THE SAME AS POCKET SIDE)

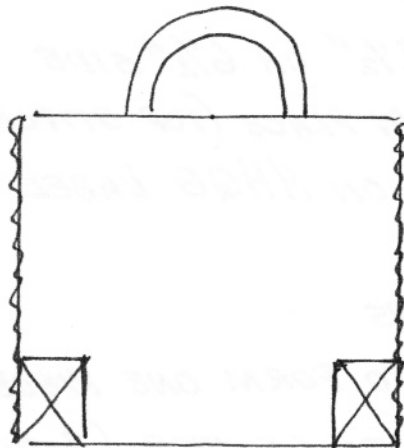

△ STITCH IN PLACE STARTING AT TOP OF POCKET SIDE, REPEAT ON OTHER SIDE (REINFORCE TOP OF POCKET, BOTTOM OF POCKET AND SAME DISTANCE DOWN FROM POCKET ON BACK SIDE OF TOTE)

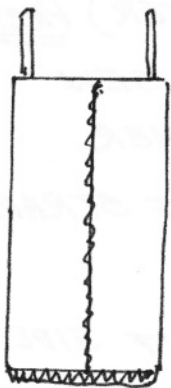

△ FOLD RIGHT SIDES TOGETHER STITCH USING (A) SERGER (B) OVERCAST STITCH OR (C) $\frac{1}{4}$ " and $\frac{1}{2}$ " SEAM ON BOTH SIDES

△ CUT 3" SQUARE BOTTOM CORNER STITCH BOTTOM CLOSE TO FORM BAG BOTTOM

★ TURN BAG OUT IT'S FINISH!!

Thank you for your time and assistance. GERI